

RK
COMPRESSORS

AC-560V-230



Illustrated Part List



Équipements ESF inc.
6500, Armand-Viau Street
Quebec (Qc) Canada G2C 2J6
T (418) 845-2318
F (418) 845-5252
www.esfdirect.com



| Model | AC-560V-230 | |
|-----------------|---------------------------|--------------|
| Pump | Type | AC-3065A |
| | CFM@150 psi | 18.5 |
| | RPM | 1230 |
| Air Receiver | Capacity (gal) | 60 |
| | psi max | 150 |
| Electric Motor | HP | 5 |
| | Phase | 1 |
| | RPM | 3600 |
| | Current (amp) at start up | 121 |
| | in continuous service | 22 |
| Pressure Switch | (psi) | 100/125 |
| Voltage | (V) | 230 |
| Dimensions | L x W x H (in) | 31 x 20 x 68 |
| | Weight (lbs) | 280 |

AC-560V-230



Electric Motor Side

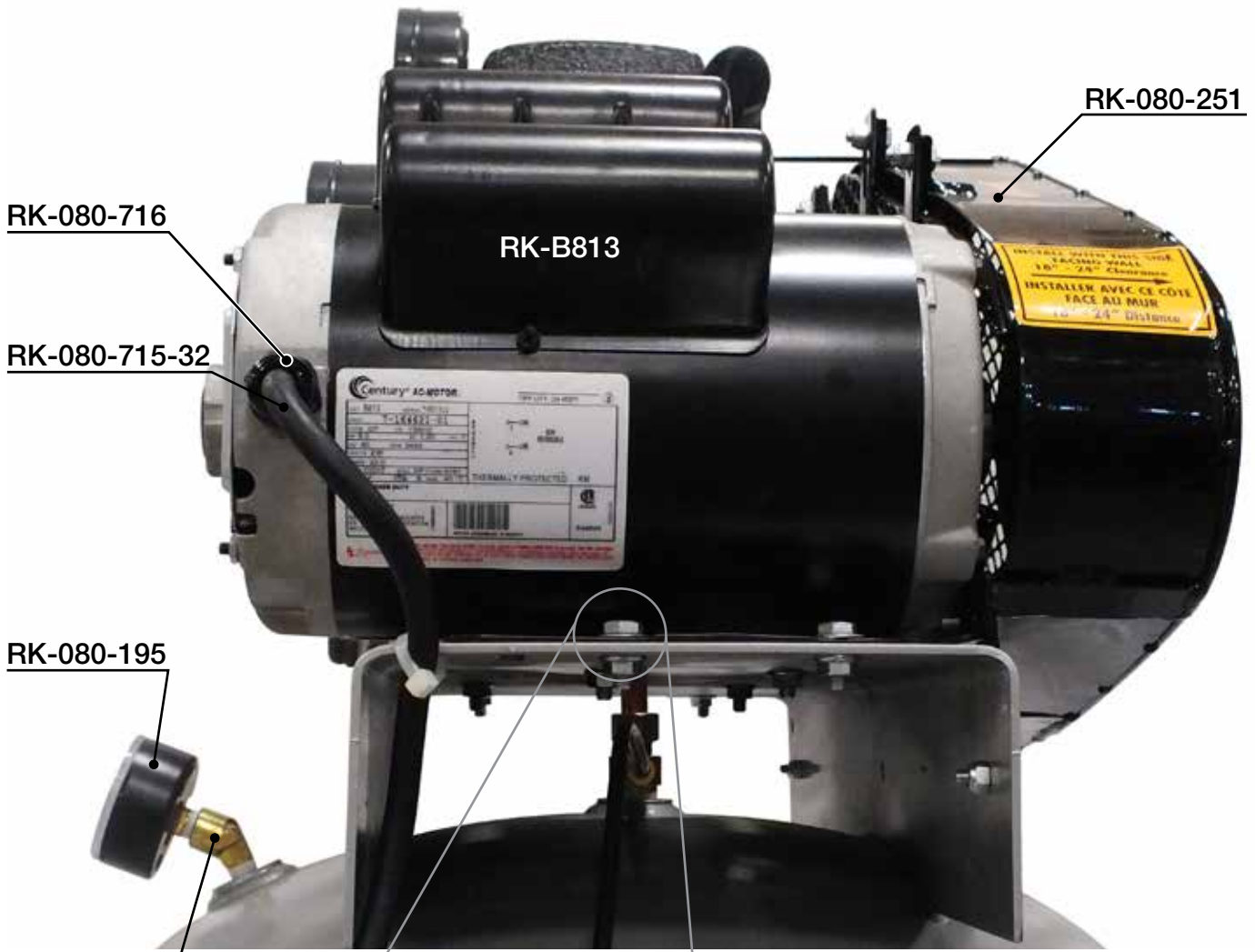

RK-080-167



800-137 (bolt)

800-304 (washer)

800-214 (nut)

Pump Side

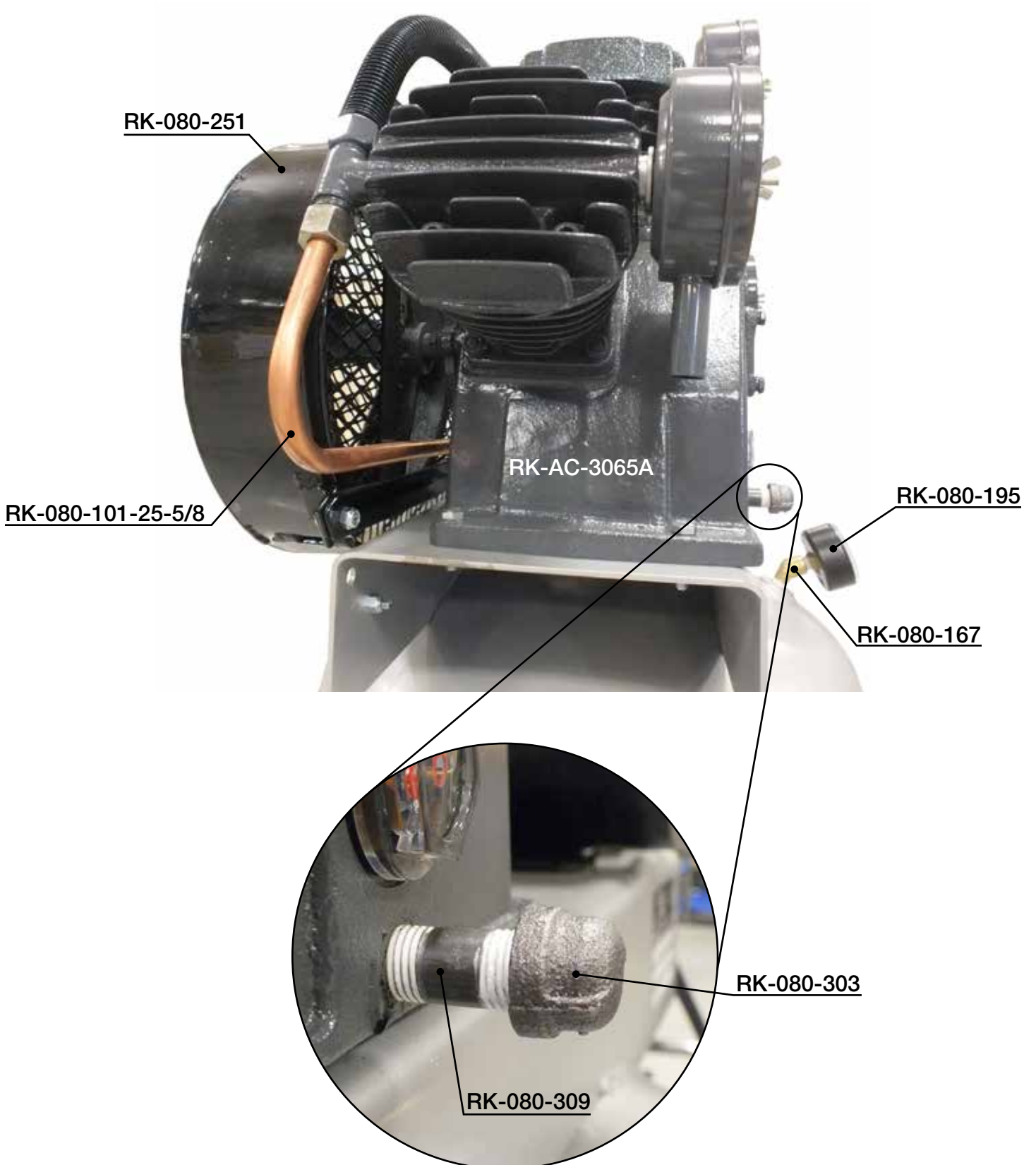

Pressure Switch

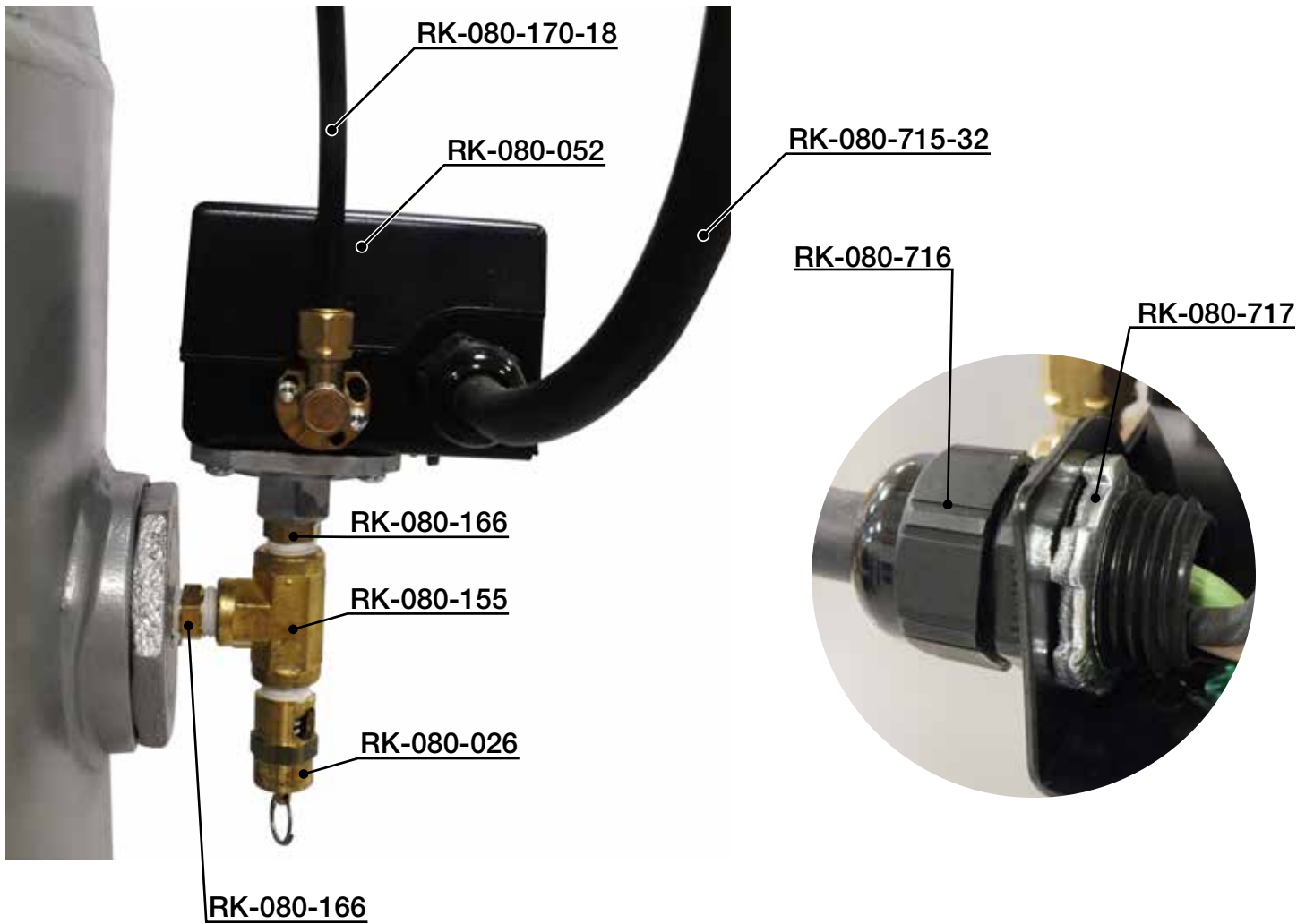

Motor Pulley and Belt

RK-080-222 - Pulley



RK-080-200 - Belt

Drain Cock

RK-080-140



RK-080-310

RK-080-314

RK-080-302

Check Valve

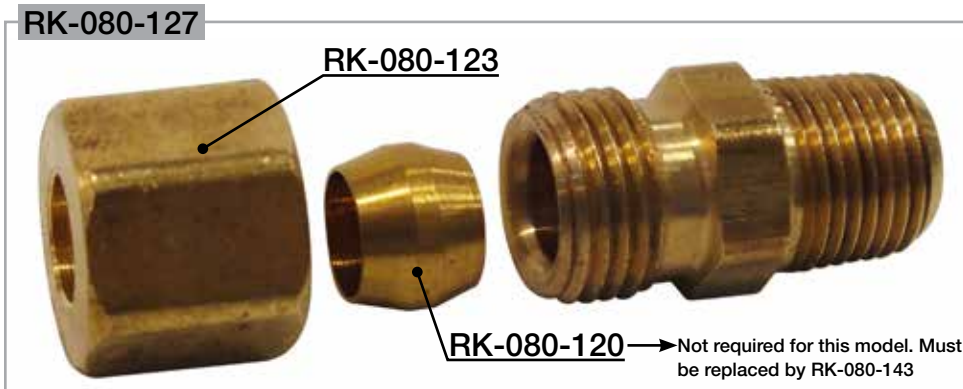

Belt Guard



Bolts, nuts and washer used on the belt guard are the following:
800-115 (bolts), quantity : 8
800-200 (nuts) , quantity : 7
800-304 (washer), quantity : 1

Decals

5 HP

RK-080-600

ATTENTION
Refer to owner's manual
for wiring instructions.
Use copper conductors only.
Voir manuel d'opérateur
pour les instructions d'installation
Utiliser des conducteurs
de cuivre seulement.

RK-080-620

RK
COMPRESSORS

RK-080-606

ATTENTION
DRAIN MOISTURE EVERY WEEK.
ENLEVER L'HUMIDITE TOUTES LES SEMAINES.
PREVENT • ÉVITER
CORROSION

RK-080-615

**INSTALL WITH THIS SIDE
FACING WALL**
18" - 24" Clearance
→
**INSTALLER AVEC CE CÔTÉ
FACE AU MUR**
18" - 24" Distance

RK-080-619

ROTATION

RK-080-618



RK-080-616

Part List

| Part Number | Description | Qty |
|-------------------|--|-----|
| RK-304768 | TANK, 60 GAL. VERTICAL | 1 |
| RK-B813 | MOTOR 5HP/230V/3600RPM/1PH | 1 |
| RK-AC-3065A | 5HP RK COMPRESSOR PUMP (single stage) | 1 |
| RK-080-016 | CHECK VALVE MALE, IN-TANK | 1 |
| RK-080-026 | SAFETY VALVE 140 PSI | 1 |
| RK-080-052 | PRESSURE SWITCH 95/125 HD | 1 |
| RK-080-059 | PLASTIC CAP | 1 |
| RK-080-101-25-5/8 | REFRIG. COPPER TUBING 1/2" (25-5/8") | 1 |
| RK-080-120 | COMPRESSION SLEEVE 1/4" | |
| RK-080-121 | COMPRESSION SLEEVE 1/2" | 1 |
| RK-080-123 | COMPRESSION NUT 1/4" | |
| RK-080-124 | COMPRESSION NUT 1/2" | 1 |
| RK-080-127 | COMP CONNECTOR 1/4" X 1/8" | 1 |
| RK-080-140 | DRAIN COCK (EXTERNAL SEAT) | 1 |
| RK-080-143 | DELFIN SLEEVE 1/4" | 1 |
| RK-080-155 | 1/4 FORGED PIPE TEE | 1 |
| RK-080-166 | HEX PIPE NIPPLE 1/4" | 2 |
| RK-080-167 | 1/4" X 45° STREET ELBOW | 1 |
| RK-080-170-18 | NYLON AIR BRAKE TUBING 1/4 (18") | 1 |
| RK-080-195 | PRESSURE GAUGE, 2.5" 1/4" CBM 300 PSI DRY | 1 |
| RK-080-200 | BELT, 54" | 1 |
| RK-080-222 | PULLEY FOR AC-560V | 1 |
| RK-080-251 | BELT GUARD, AC-560V | 1 |
| RK-080-302 | 1/4" COUPLING | 1 |
| RK-080-303 | MALLEABLE IRON CAP 1/4" | 1 |
| RK-080-309 | NIPPLE 1/4" X 1-1/2" | 1 |
| RK-080-310 | 6" X 1/4" LONG NIPPLE | 1 |
| RK-080-314 | 1/4" X 90° STREET ELBOW | 1 |
| RK-080-600 | DECAL BLACK 5HP | 1 |
| RK-080-606 | RK DECAL LARGE BLACK 7" X 15" | 1 |
| RK-080-615 | DECAL CORROSION 3" X 2-7/8" | 1 |
| RK-080-616 | DECAL MADE IN CANADA 1-7/8" X 5" | 1 |
| RK-080-618 | DECAL ARROW 3/4" X 3" | 1 |
| RK-080-619 | DECAL CLEARANCE | 1 |
| RK-080-620 | DECAL ATTENTION (grey) | 1 |
| RK-080-715-32 | WIRE 300V .430 - 32" | 1 |
| RK-080-716 | CABLE CONNECTOR | 2 |
| RK-080-717 | NUT CABLE CONNECTOR 1/2" | 1 |

| Part Number | Description | Qty |
|-------------|-------------------------------------|-----|
| 800-115 | HEX BOLT 1/4"x 3/4" GR5 PLZN | 8 |
| 800-134 | HEX BOLT 5/16"x 1 1/4" GR5 PLZN | 4 |
| 800-137 | HEX BOLTUNC 5/16"x 3/4" GR5 PLZN | 4 |
| 800-200 | LOCK NUT 1/4-20 PLZN | 7 |
| 800-214 | FLANGE LOCK HEX NUT 5/16 NC PLZN | 8 |
| 800-304 | FLAT WASHER 1/4 PLZN | 5 |